



**Notice to Bidders for Letting of May 14, 2025**

**ADDENDUM NO. 1 – Issued May 09, 2025**

**REQUEST FOR PROPOSALS –  
EXTERIOR CONCRETE STAR REPAIR  
MARQUETTE SAWYER REGIONAL AIRPORT**

This Addendum changes the terms of the Bid Proposal. By submitting a bid, you accept all changes included in this Addendum. Bidders are required to acknowledge receipt of this Addendum in the space provided on the Proposal Forms.

The following paragraphs and the attached pages will instruct you as to the changes made and how to make them.

**CHANGES TO BID ITEM PAGES**

When you are instructed to **ADD, DELETE, or MAKE CHANGES** to a **BID ITEM PAGE OR PAGES**, these additions, deletions, or changes **MUST** be made on the bid item pages you submit with your bidding proposal, whether handwritten or computer generated.

**CHANGES TO OTHER PAGES**

When you are instructed to **DELETE** something which is **NOT** on a Bid Item Page, you may line through the text diagonally and/or print or write the word **“DELETE”** on the text being deleted. Physically removing the page(s) is not necessary.

When you are instructed to **ADD A NON-BID ITEM PAGE(S), OR PORTIONS THEREOF**, you **MUST CONSIDER** it/them in developing your bid, but the physical insertion of the new page(s) into the proposal is not necessary.

**FAILURE TO CARRY OUT THE INSTRUCTIONS IN THIS ADDENDUM MAY  
RESULT IN THE  
REJECTION OF YOUR BID.**

Prospective bidders on the above project are hereby advised of the following changes:

**PROJECT CHANGES:**

1. ADD

**Specification: Stair Replacement – Detailed Specification**

**1. Scope**

This section covers the complete removal and replacement of the exterior stairway , including the structural base, risers, and treads or adjacent concrete work.

---

**2. Demolition**

- Remove the existing stair system entirely, including concrete, subgrade material, and attachments.
  - Avoid damage to adjoining structures and pavement.
  - Dispose of demolition debris off-site in accordance with local regulations.
- 

**3. New Stair Configuration**

- **Width:** New stair system shall have a total clear width of **12 feet**.
- **Number and Dimensions of Steps:**
  - The stair configuration shall match existing slope and rise/run standards for code compliance (refer to local building codes or ADA requirements, if applicable).
  - **Tread Depth:** 11 inches minimum (or per local code).
  - All risers and treads shall be **uniform** throughout the entire stairway.
  - Ensure slope and elevation transitions match adjacent sidewalks or landings.
  - Concrete shall be 5,000 psi compressive strength at 28 days.
- **Resizing detail for east side steps**
  - Pour new concrete sidewalk in areas revealed by stair resizing, to fill the gap between new stair width and existing sidewalks.
  - Match finish, color, and pattern (if any) to the existing surrounding concrete.
  - Thickness of sidewalk to be a minimum of **4 inches**, or as per adjacent slab thickness.

- 

#### 4. Formwork and Reinforcement

- Construct formwork to ensure accurate dimensions and clean, true edges.
  - Reinforce stairs with **#4 rebar at 12" o.c. each way**, both vertically and horizontally, or as specified in structural drawings.
  - Provide adequate concrete cover over all reinforcement per ACI 318.
- 

#### 5. Surface Leveling and Finishing

- Ensure all new concrete is **level and flush** with adjacent surfaces for smooth, continuous transitions.
  - Use appropriate formwork and screeding methods to ensure flatness and proper drainage slope.
  - Apply a broom finish or match to existing texture, with tooled or saw-cut control joints as necessary.
- 

#### 6. Subgrade Preparation

- Compact the exposed subgrade to **95% Standard Proctor Density**.
- 

#### 7. Formwork and Reinforcement

- Construct formwork to ensure accurate dimensions and clean, true edges.
  - Reinforce stairs with **#4 rebar at 12" o.c. each way**, both vertically and horizontally, or as specified in structural drawings.
  - Provide adequate concrete cover over all reinforcement per ACI 318.
-

## EXTERIOR CONCRETE STAR REPAIR

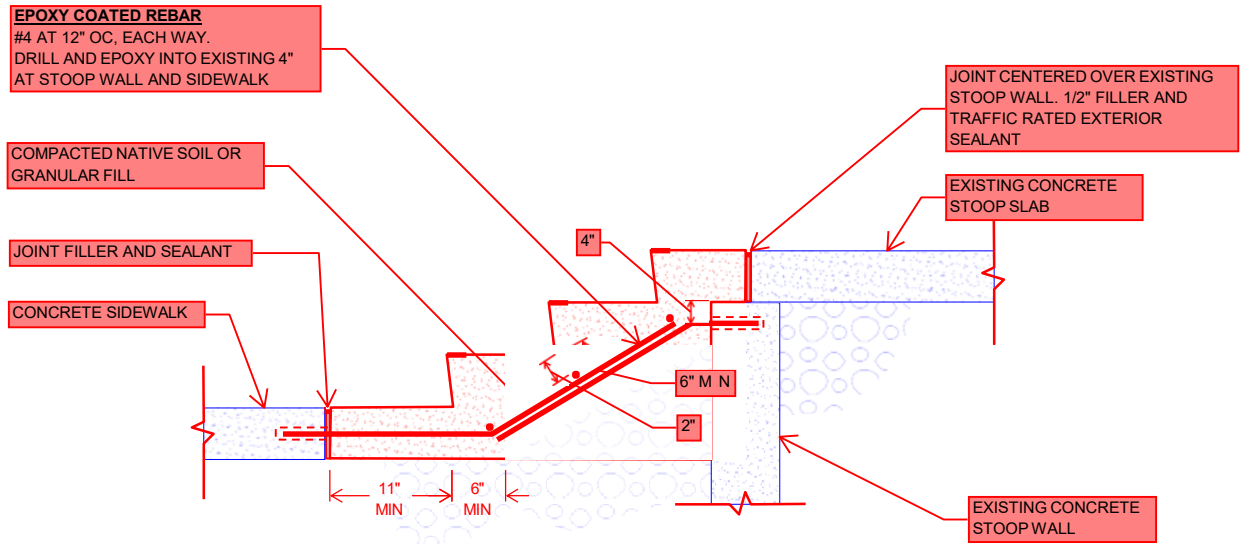

CONCRETE MIXTURE CLASS SCHEDULE													
CLASS	APPLICATION	MINIMUM COMPRESSIVE STRENGTH	WEIGHT	EXPOSURE F FREEZE THAW	EXPOSURE S SULFATE	EXPOSURE W WATER	EXPOSURE C CORROSION	MAXIMUM W/CM RATIO	SLUMP LIMIT	AIR CONTENT	MAXIMUM AGGREGATE SIZE	DRYING SHRINKAGE	MAXIMUM GLOBAL WARMING POTENTIAL
K	EXTERIOR FLATWORK (STOOP SLABS)	5000 PSI AT 28 DAYS	NW	F3	S0	W1	C2	0.40	9"	4.5 ± 1.5%	1 1/2"		

Basic concrete spec, we want 5000psi concrete for increased durability.

## 6. Concrete Placement

- **Concrete Strength:** Minimum 5,000 psi at 28 days.
- Include **corrosion inhibiting admixture** in the mix, conforming to:
  - ASTM C494/C494M, Type C
  - ASTM C1582/C1582M
  - Approved products include:
    - Euclid Chemical: EUCON CIA
    - GCP Applied Technologies: DCI / DCI-S
    - Hycrete, Inc.
    - Master Builders Solutions: MasterLife CI Series
- Place concrete monolithically and vibrate to eliminate voids.
- Slope treads slightly (max 1/4" per foot) for drainage.

## 7. Finishing

- Provide a **broom finish perpendicular to the direction of travel** for slip resistance.
- Tool edges and control joints neatly.
- Match adjacent finishes and textures wherever possible.